

Cuba Bed

Assembly Instructions - Please keep for future reference

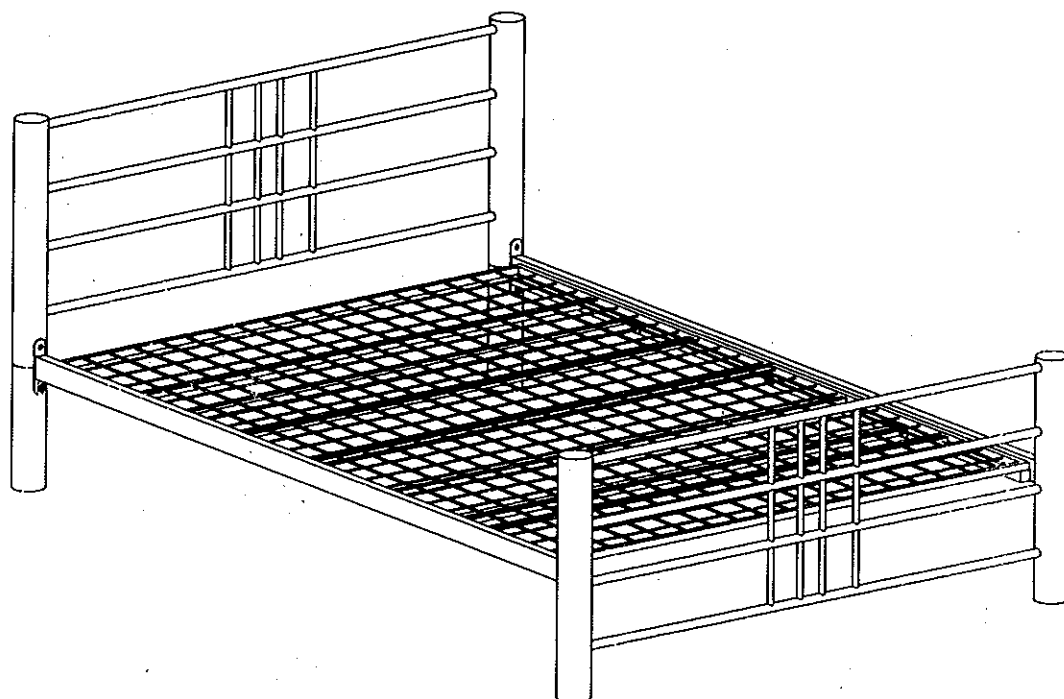

Safety and Care Advice

- Important: Please read these instructions fully before starting assembly.
- Do not discard any of the packaging until you have checked that you have all the parts and the pack of fittings.
- Discard all extra fittings and keep fittings out of reach of children.
- Assemble this product on a flat and protected surface.
- Assemble this unit in the room intended for use.
- At least 2 persons are required to assemble this unit.
- Approximate time of assembly: 60 minutes.
- Retain Assembly Instructions for future reference.

Care and maintenance:

- Please clean the product using either damp (not wet) cloth and a mild domestic soap solution or by using an appropriate polish.
- Do not use abrasive materials when cleaning this product.
- From time to time, check that there are no loose fittings on this unit.

Parts List

① HEADBOARD	x1 pc	⑤ CROSS BAR	x2 pcs
② FOOTBOARD	x1 pc	⑥ CENTRAL CROSS BAR	x1 pc
③ SIDERAILS	x2 pcs	⑦ MESH BASES	x2 pcs
④ LEGS	x2 pcs		

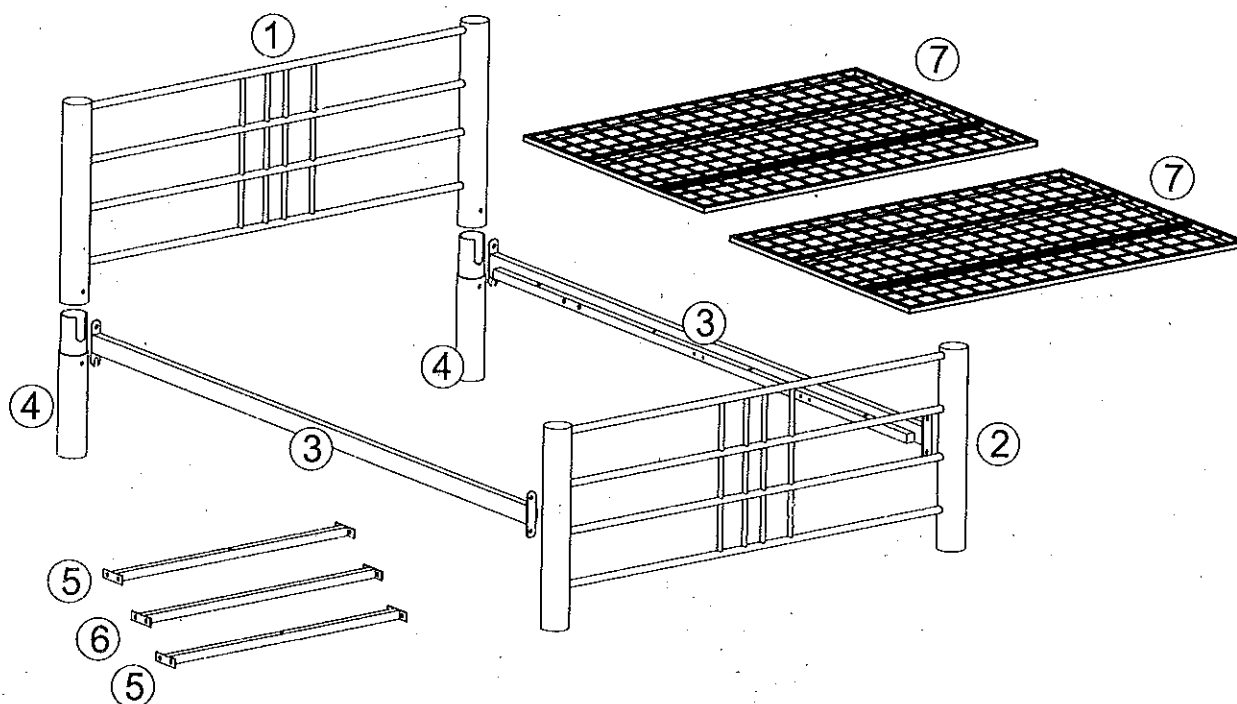

Fittings List

(A) M8x25mm BOLT - 8pcs	(B) M6x25mm BOLT -10pcs	(C) 4mm ALLEN KEY- 1pc	(D) 6mm ALLEN KEY- 1pc	(E) M6x12mm BOLT - 12pcs
--	--	---	---	---

Step 1

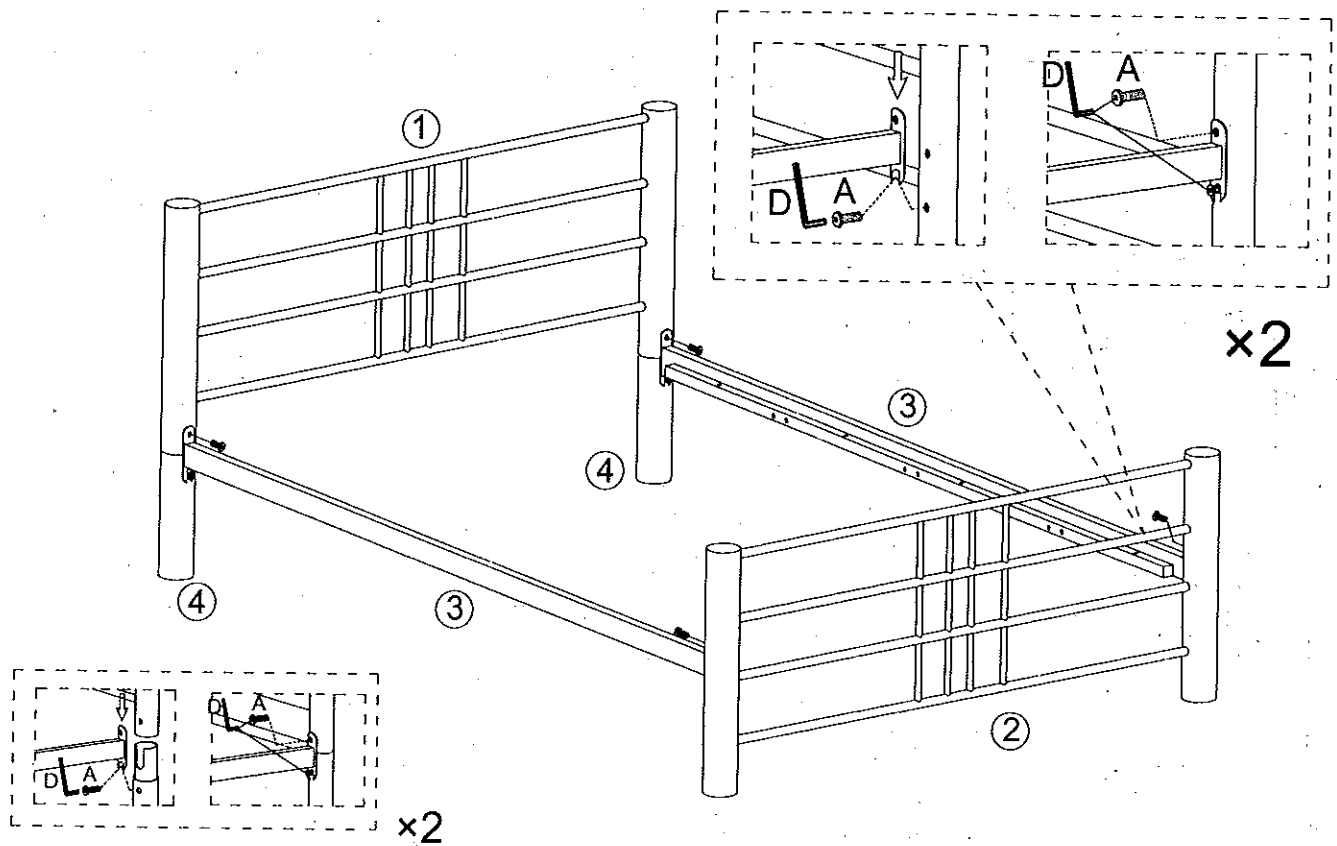

Step 2

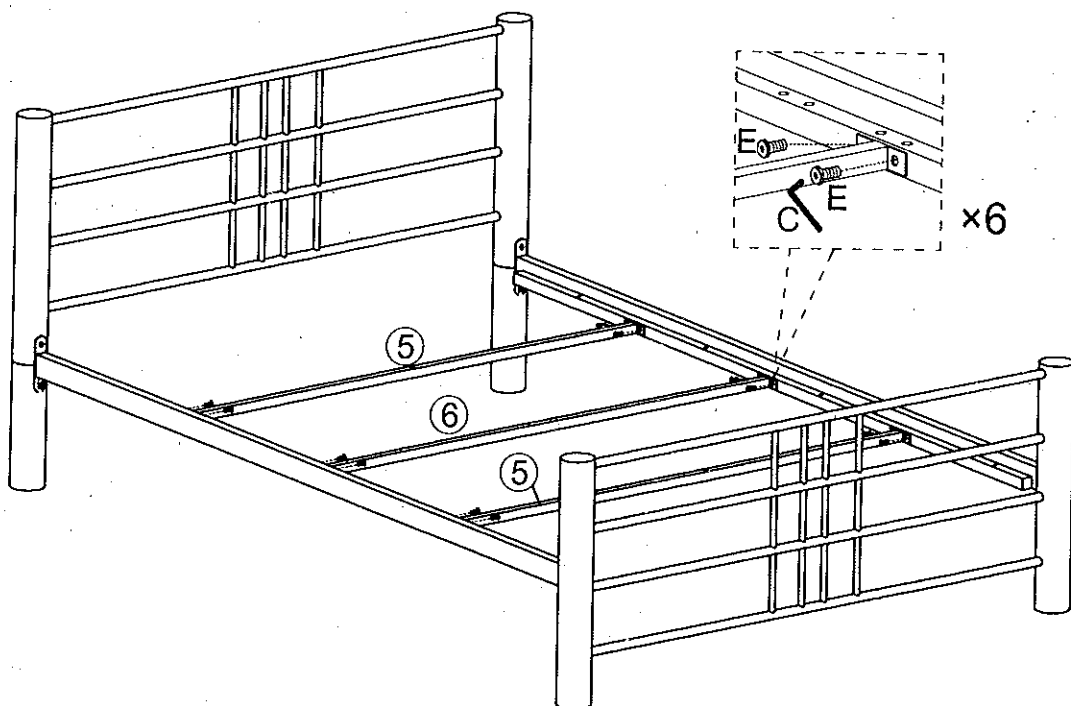

Step 3

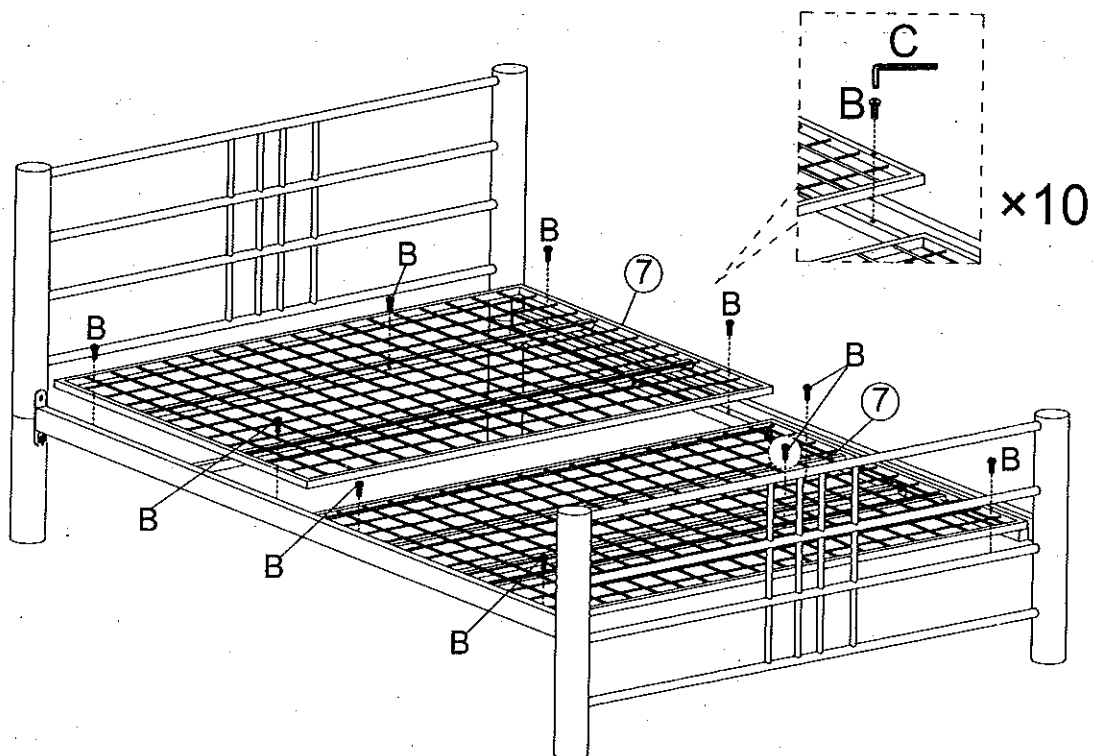

Step 4

